

Table of contents

STEP		PAGE
	T-room model 70 – basic design	2
1	inner floor and lower guide rails	3
2	erecting the wall panels	4
	B – joint floor / wall	5
	C – joint corner/walls	6
	D – joint between wall panels	7
	G – G section middle of room	8
	H – inside of wall A-C on page 13	8
3	upper guide rail	9
	E – joint wall/roof	10
4	roof panels	11
	F – joint between roof panels	12
5	inside wall covers	13
	securing the inner wall cover	14
6	electric connections	15
	installing the light	16

Note

A T-room 24x18 modules is taken as an example. However, the instructions are applicable to a T-room of any size.

T-room model 70 – basic design

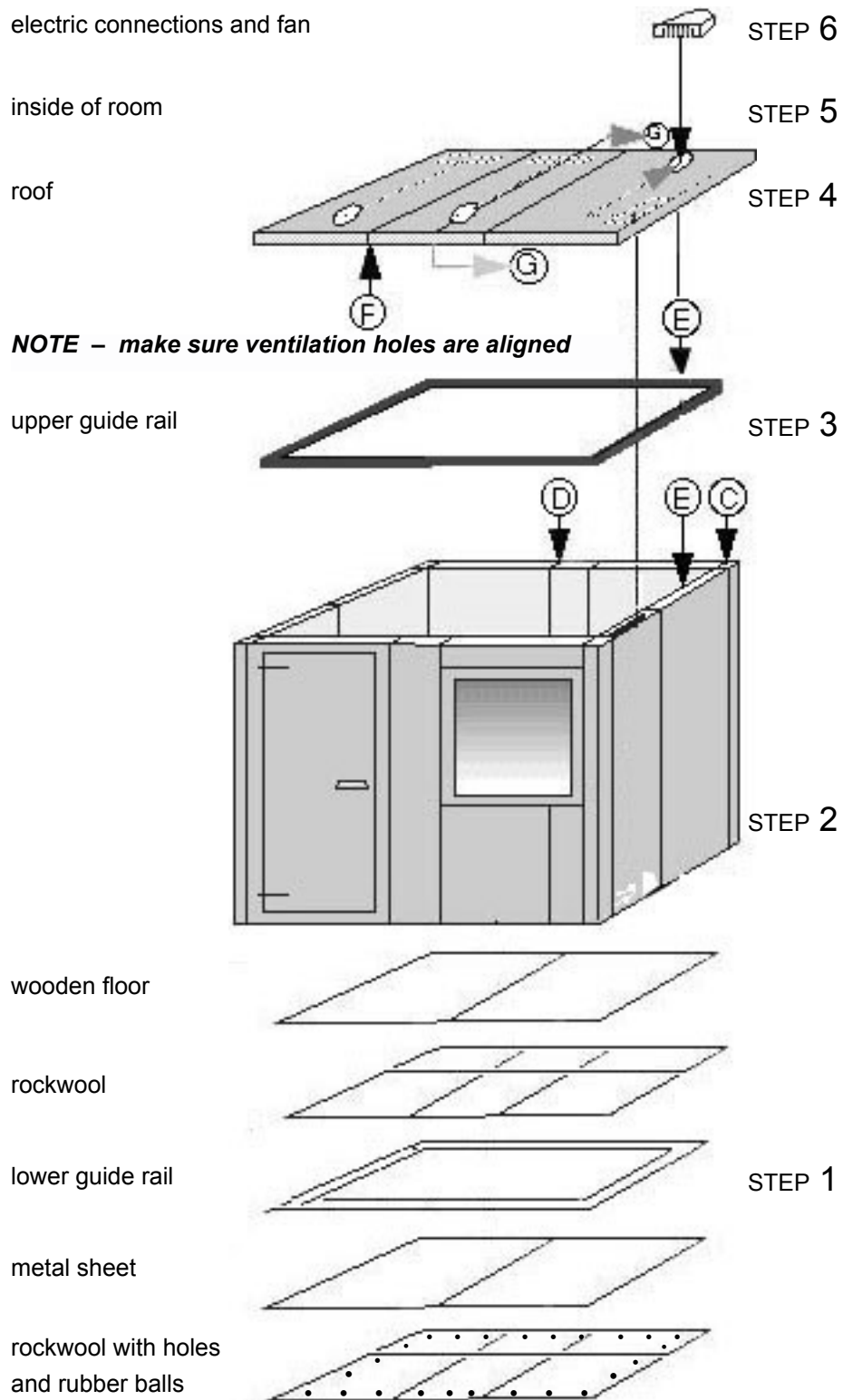

STEP 1 – inner floor and lower guide rails

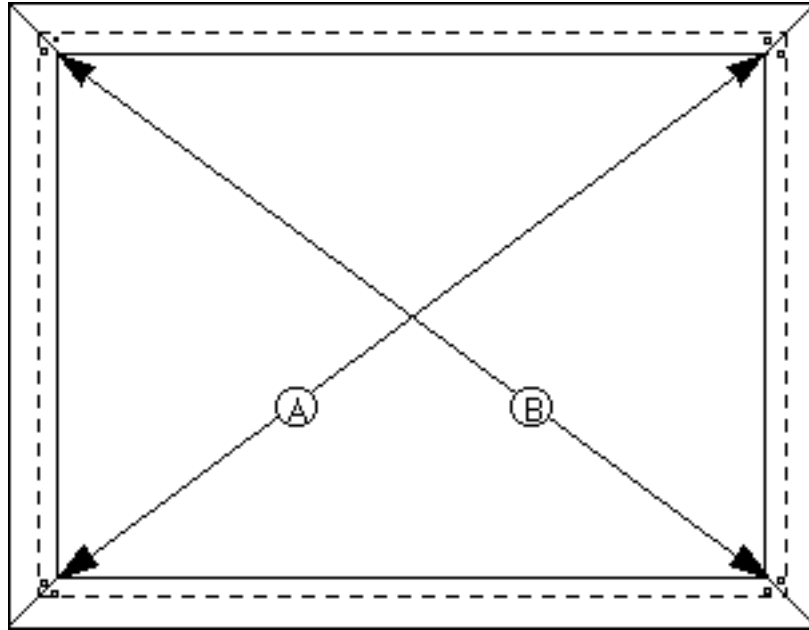

- 1 cut material for inner floor from packing case lids
- 2 screw guide rails to floor panels, making $A=B$ within 1 mm
place screws towards inner edge of guide rail (see page 5)
so that when wall panel is placed on guide rail, screw is still visible and can be adjusted (see page 5)
- 3 take measurements as shown on page 5

STEP 2 – erecting the wall panels

NOTE! after having erected the walls you need to secure them with a strap at the very top so that no wall panel falls out, and then you can put the upper guide rail in place.
DO NOT OPEN THE DOOR until the strap is securely in place.

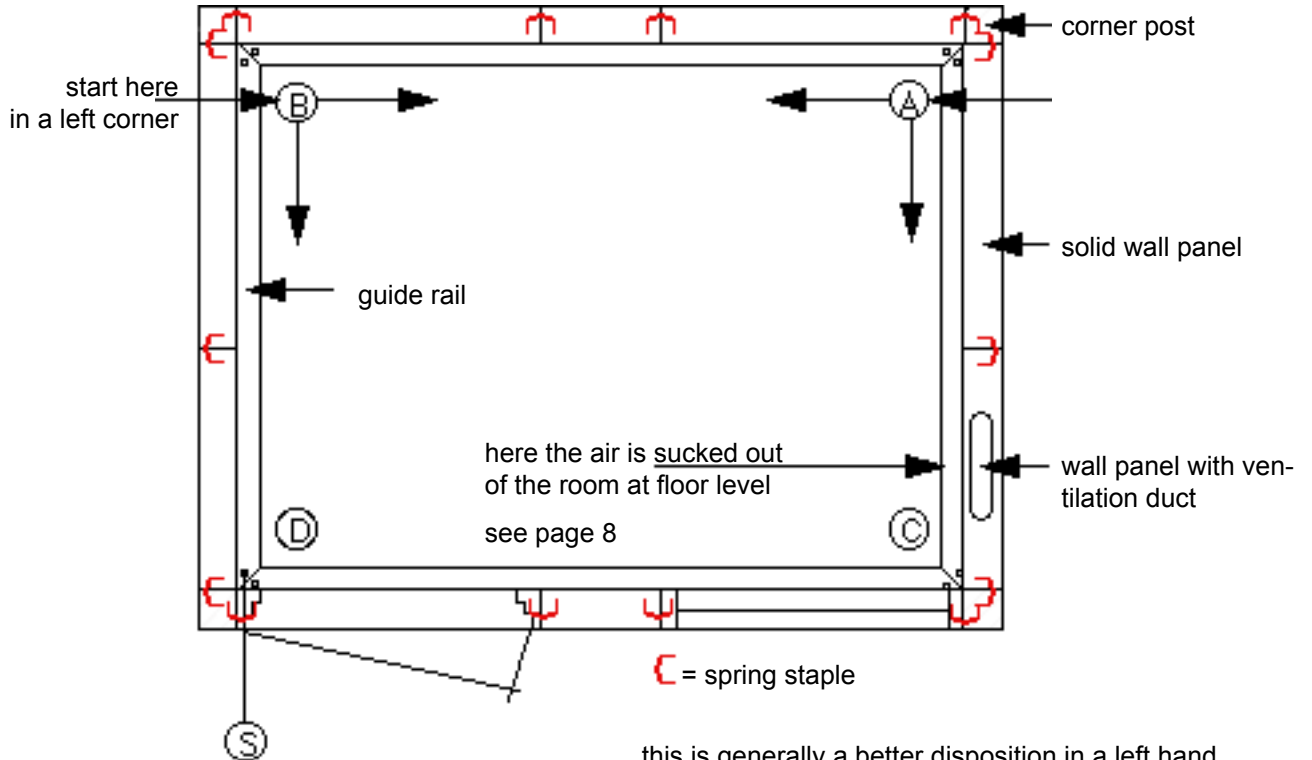

For a room placed against a right wall you have to finish the last corner by loosening the screw marked S and push that end of the wall 2,5 cm outwards to make room for the rubber seals, see page 6. Then push the wall back and replace the screw S.

this is generally a better disposition in a left hand corner

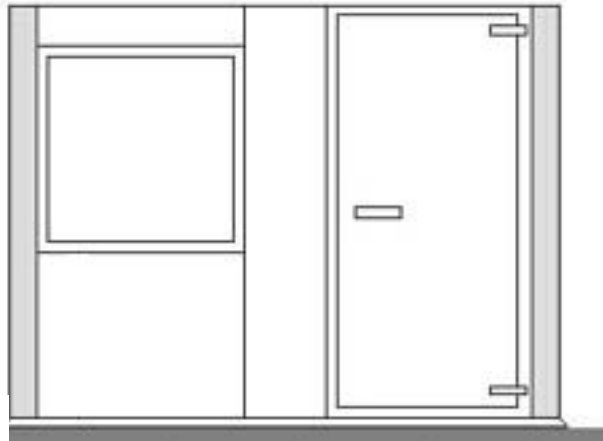

in a right hand corner, this is generally the best way to build the front wall

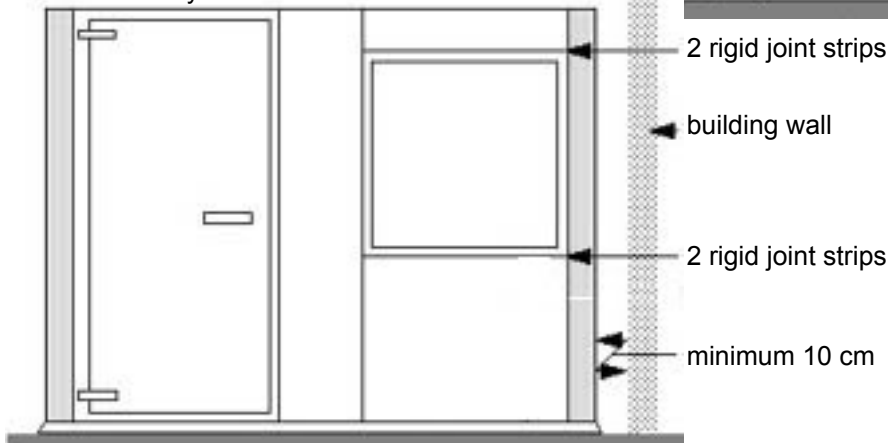

For the window wall there are 4 rigid joint strips made like this:

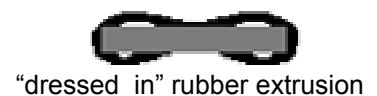

"dressed in" rubber extrusion

B – joint floor / wall

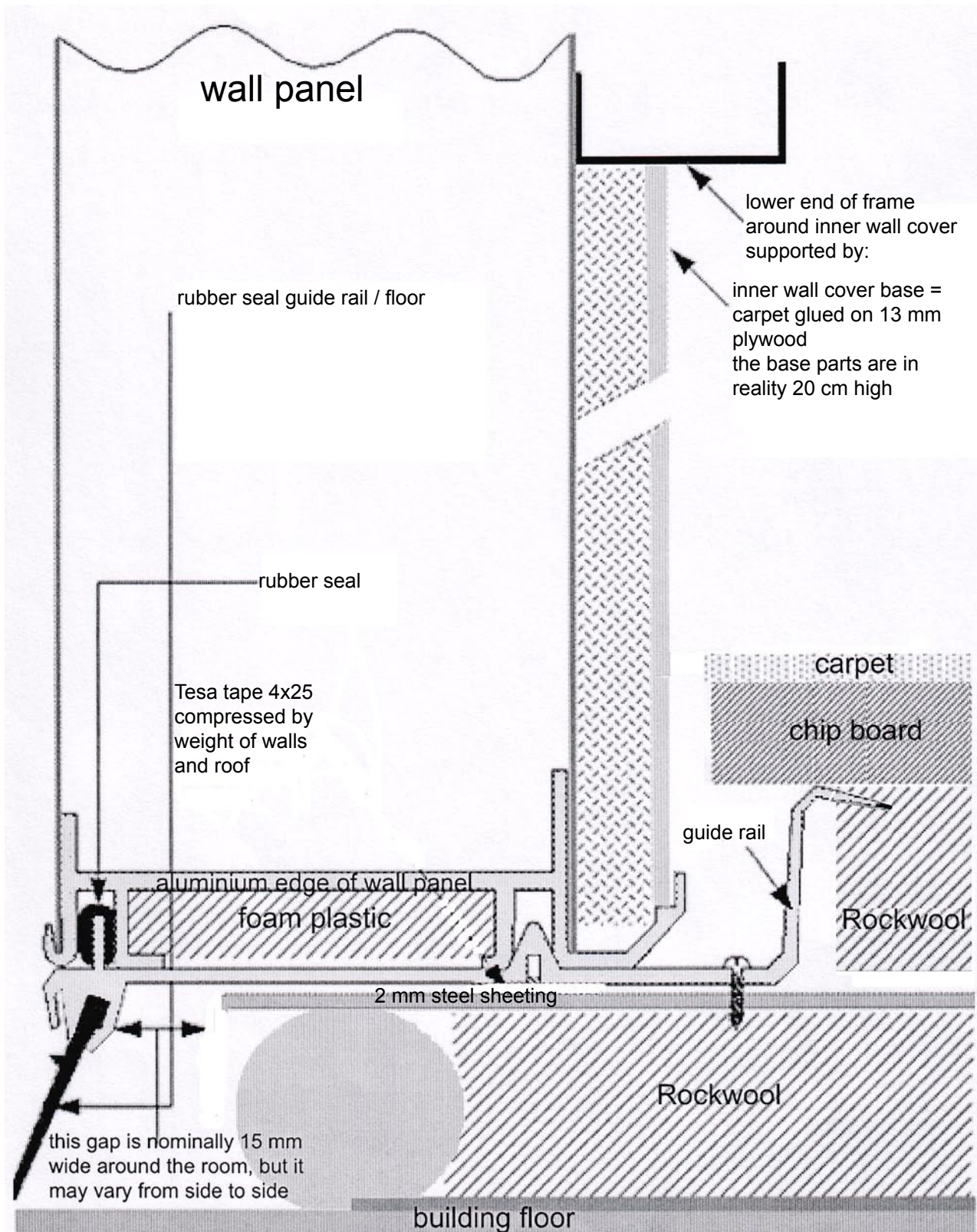

C – joint corner/walls (seen from above)

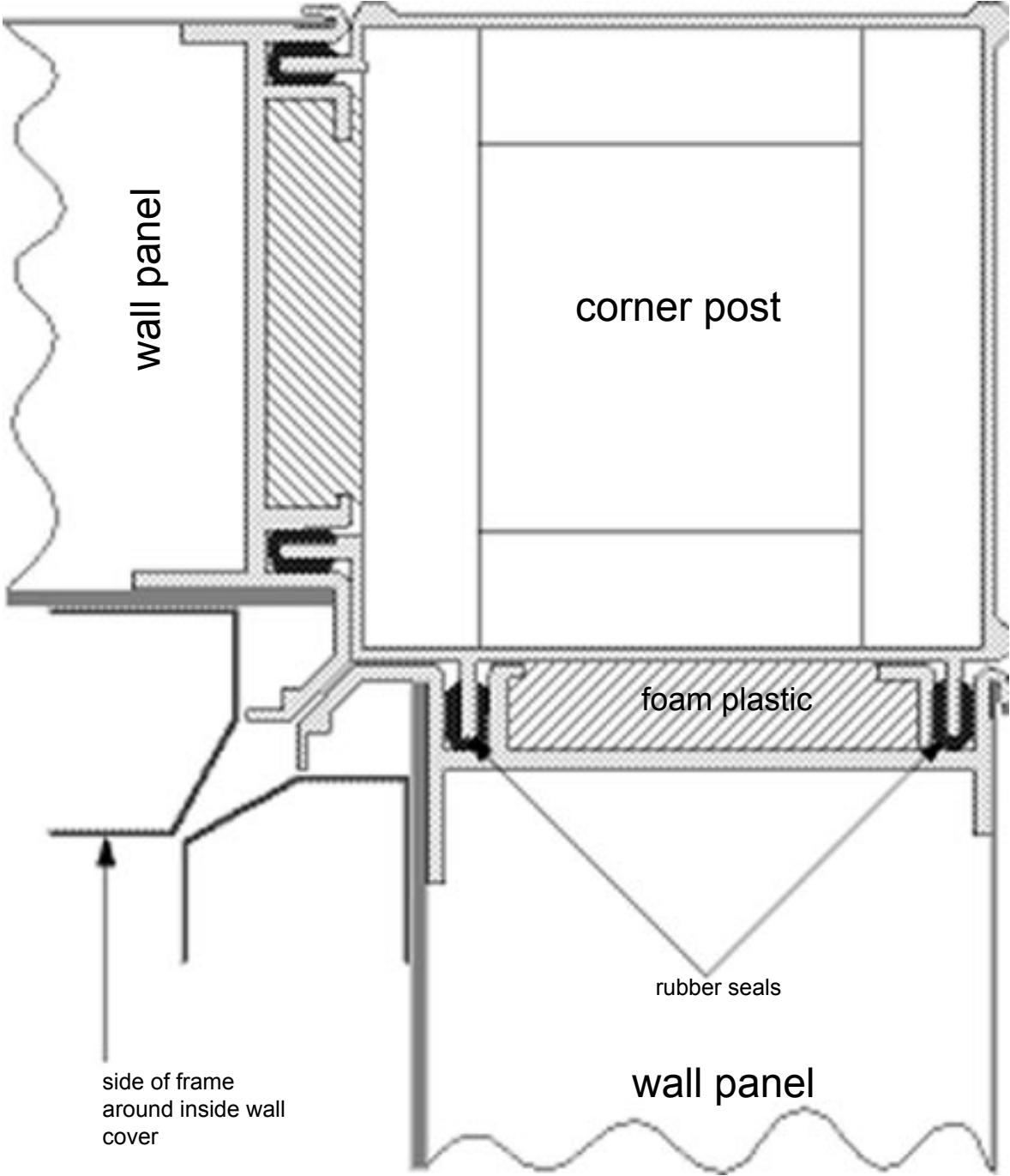

D – joint between wall panels

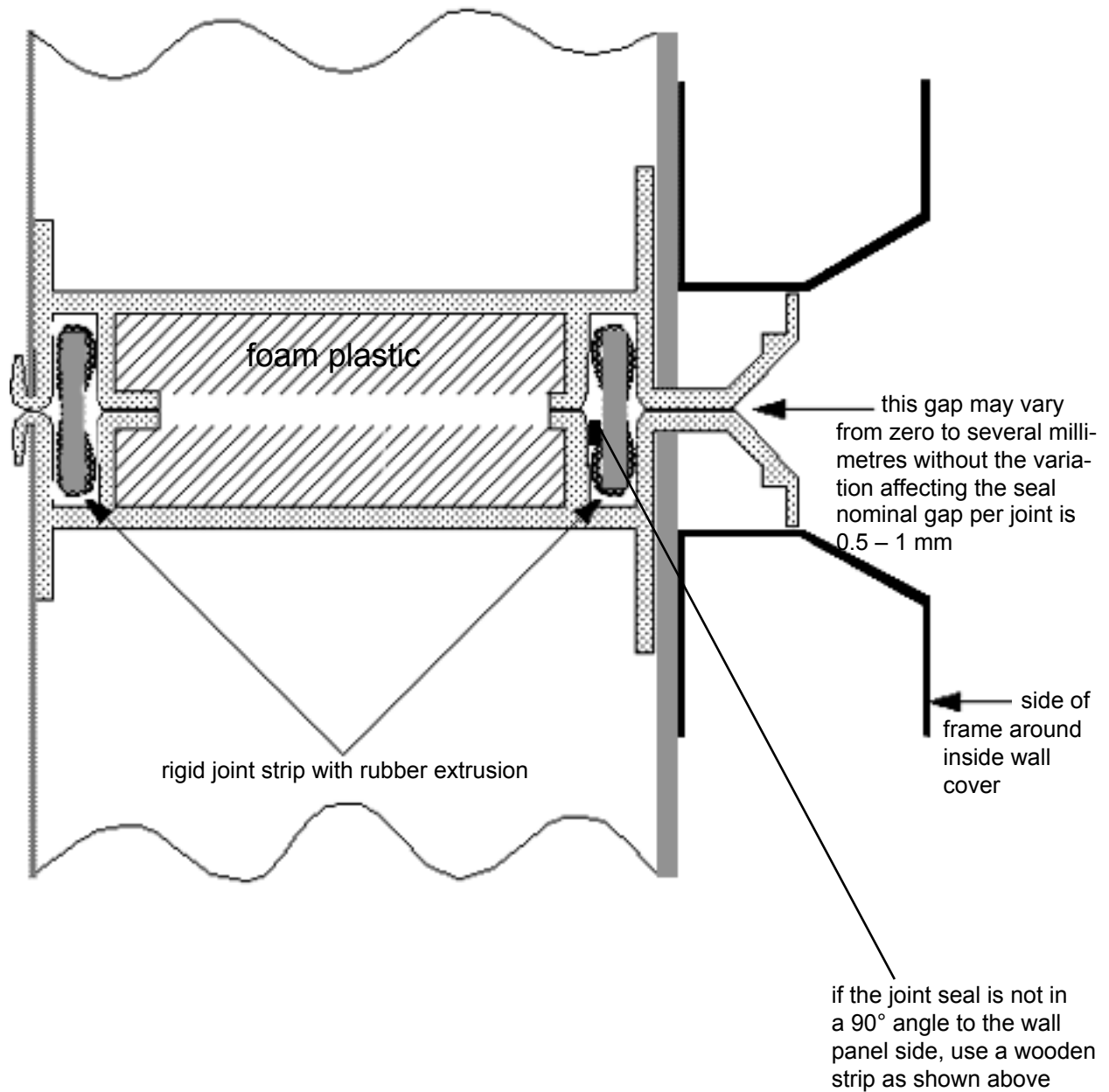

G – G section through middle of room

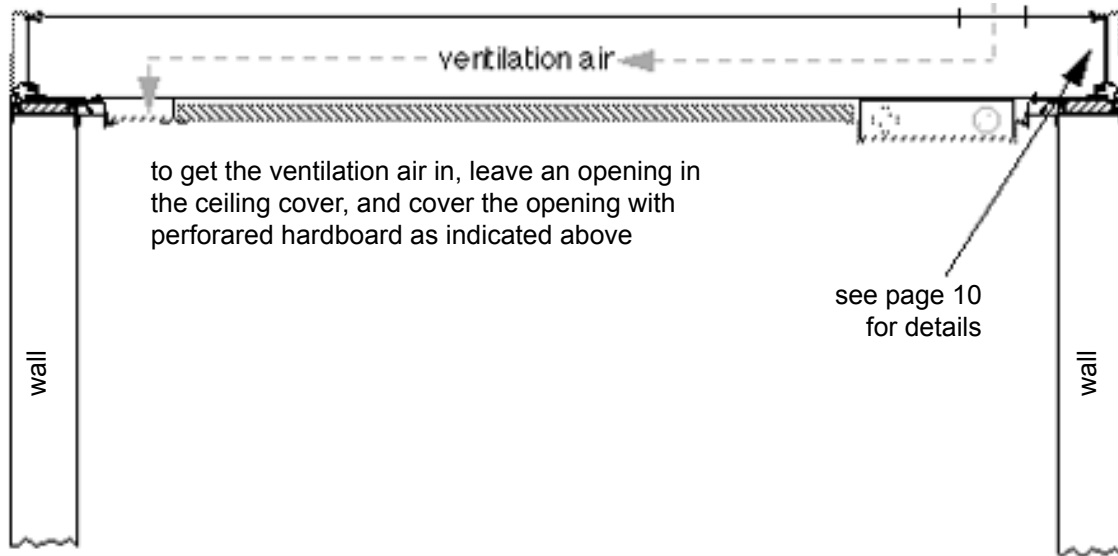

H – inside of wall A-C on page 13

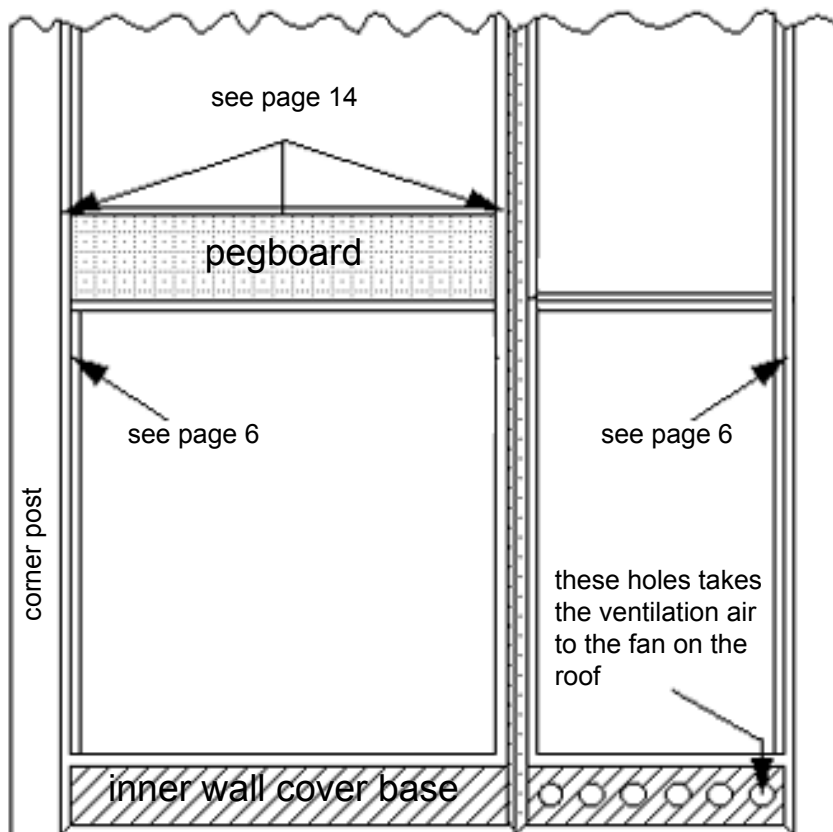

STEP 3 – upper guide rail

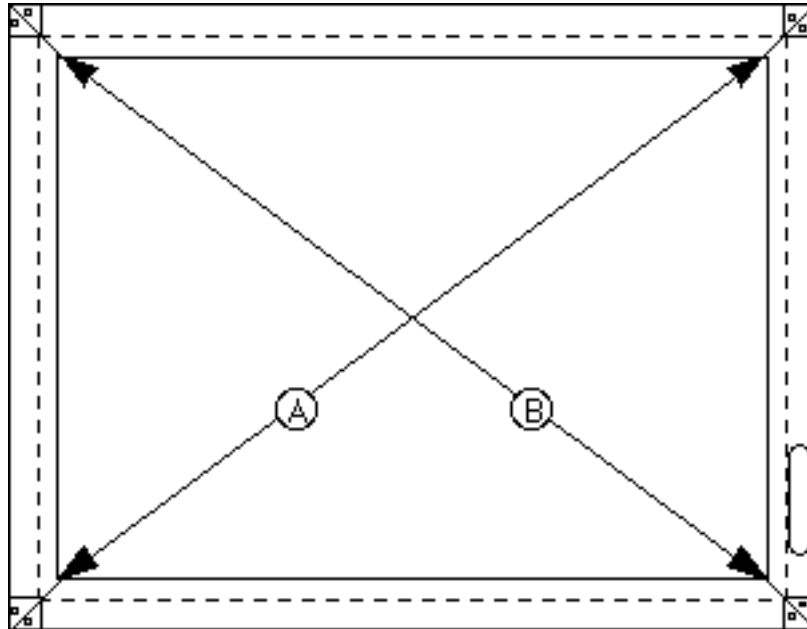

tape one strip of Tesa 4x25 on each
guide rail as shown on page 10 and
around the air hole

nail guide rails to corner posts

Important: A should be = B within ± 2 mm

if A is longer, lift an "A-corner" by putting in some extra balls

if B is longer, lift a "B-corner" in the same manner

E – joint wall/roof

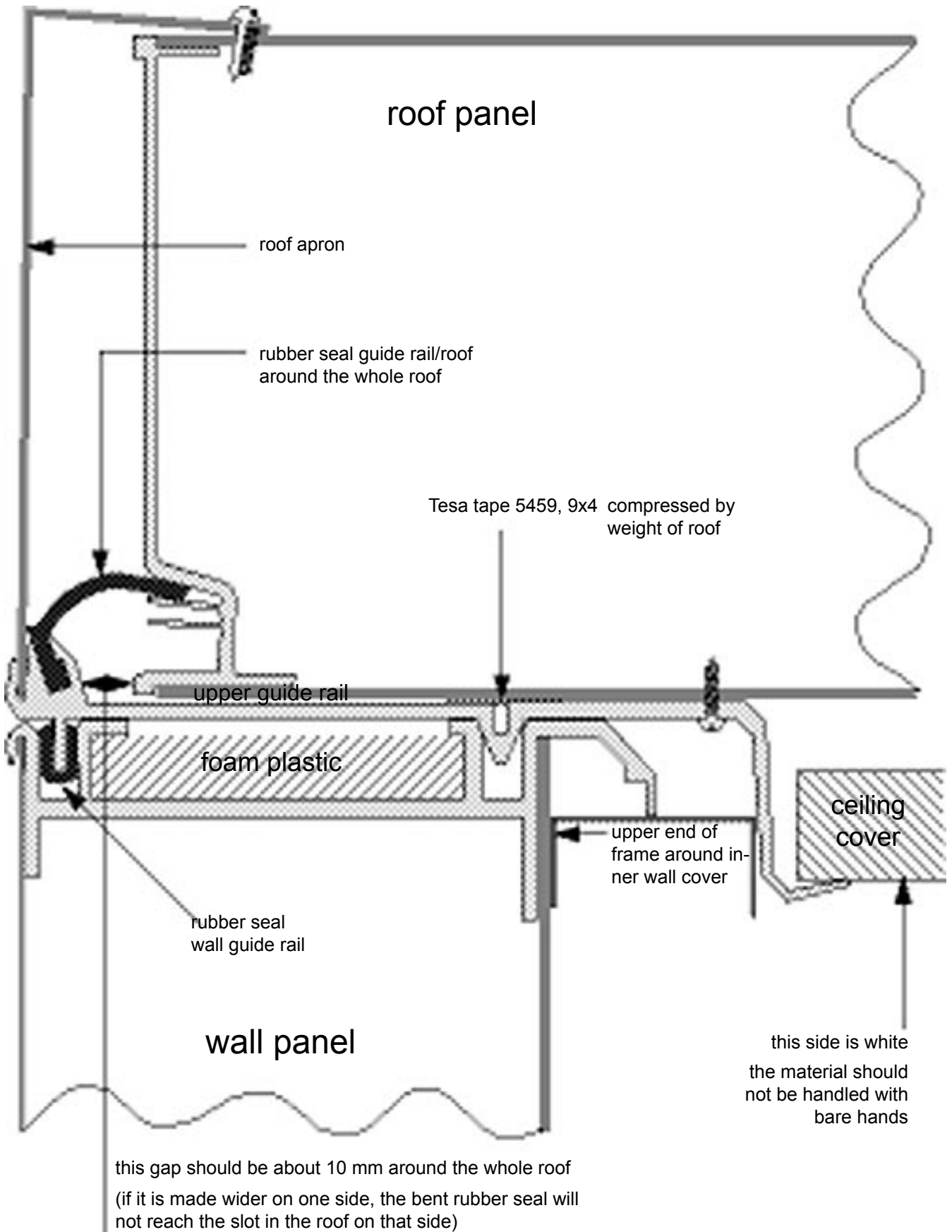

STEP 4 – roof panels

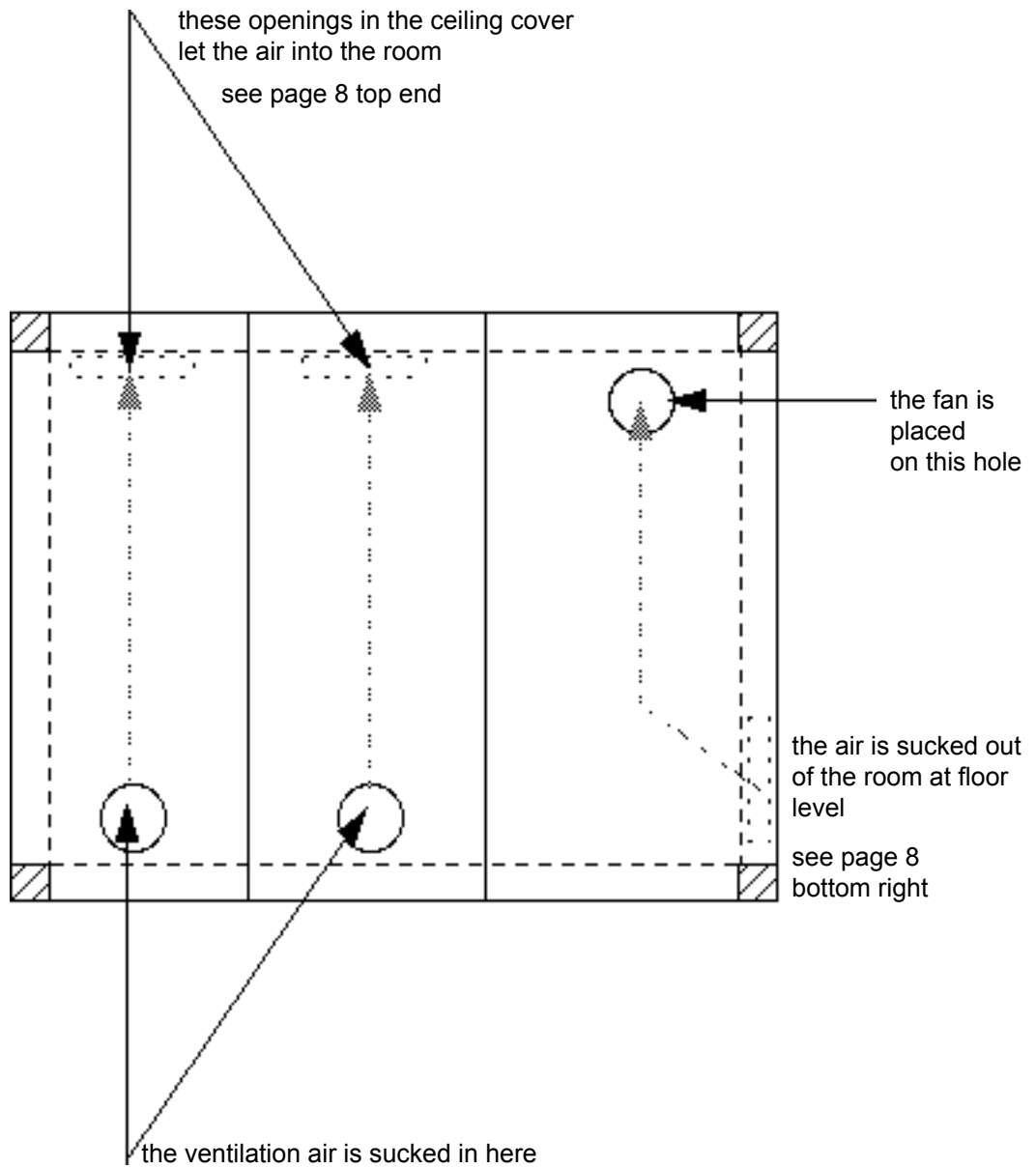

F – joint between roof panels

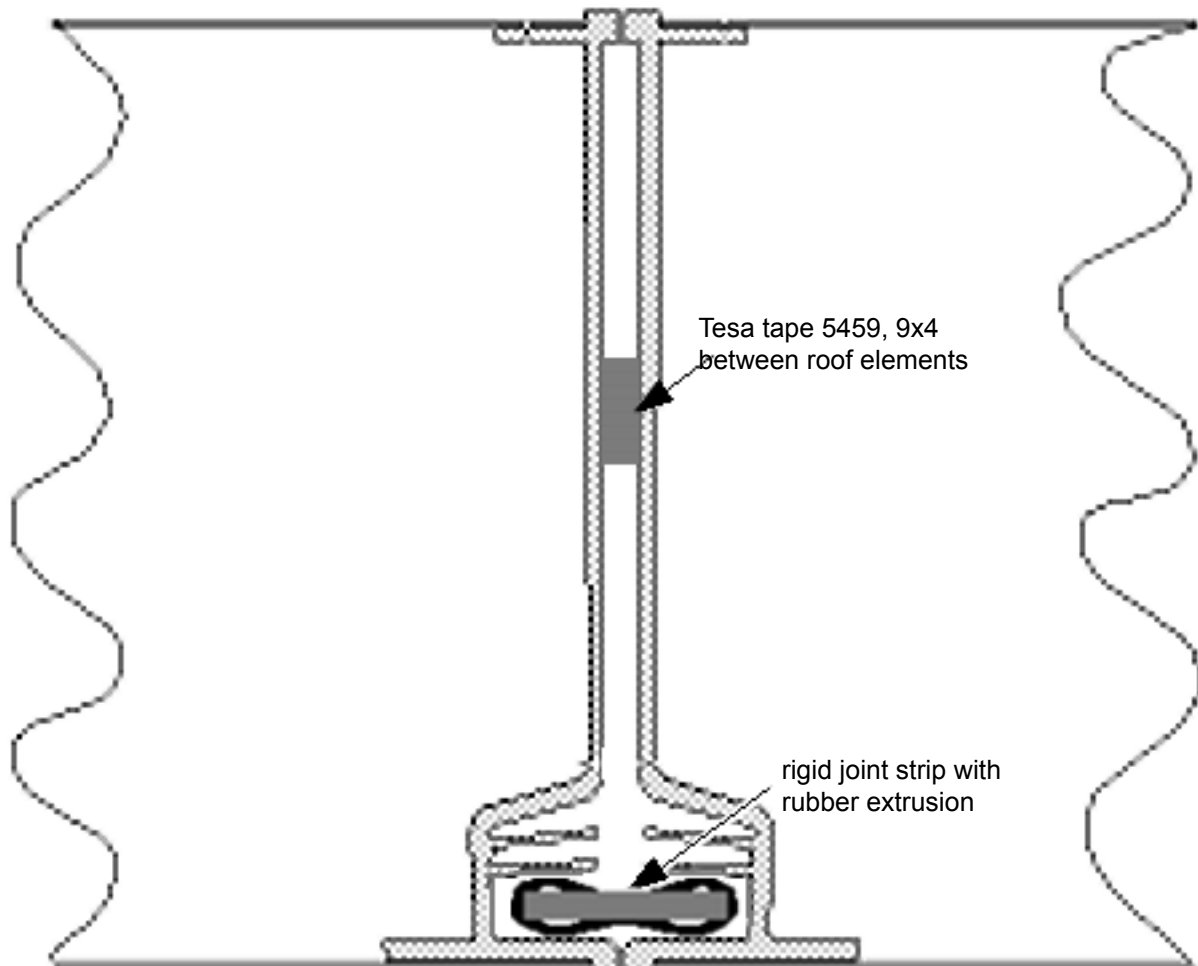

STEP 5 – inside wall covers

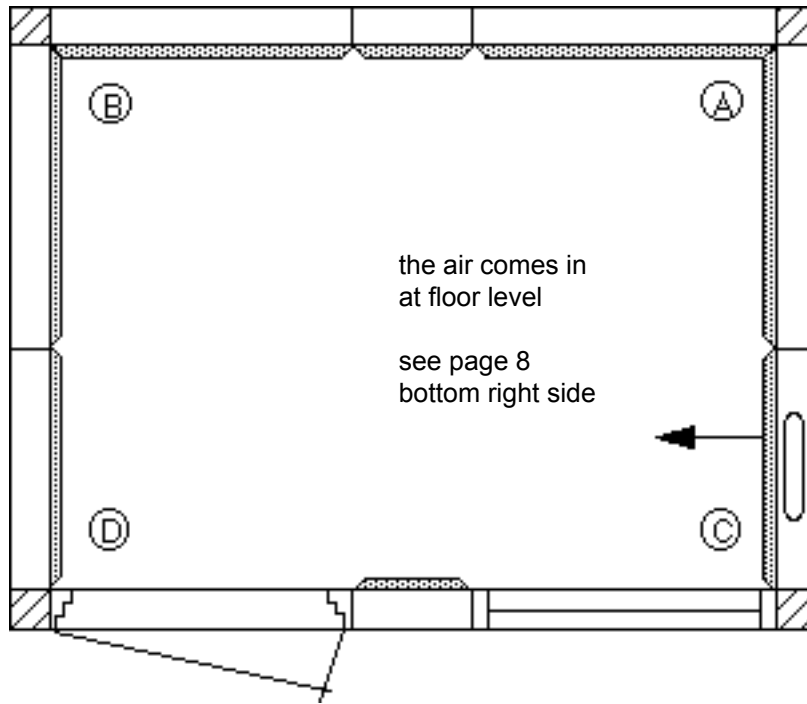

STEP 5 – securing the inner wall cover, if necessary

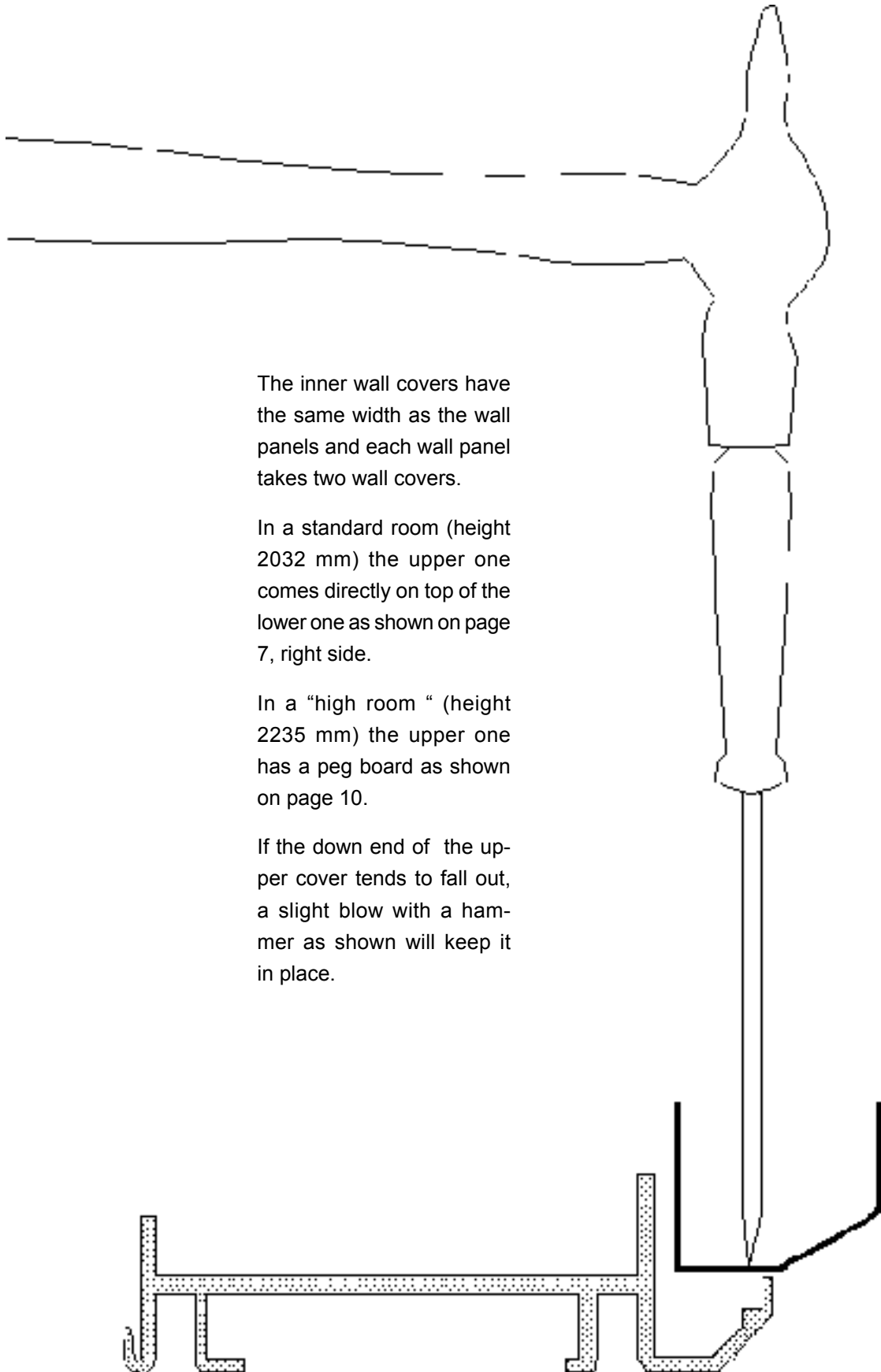

The inner wall covers have the same width as the wall panels and each wall panel takes two wall covers.

In a standard room (height 2032 mm) the upper one comes directly on top of the lower one as shown on page 7, right side.

In a “high room “ (height 2235 mm) the upper one has a peg board as shown on page 10.

If the down end of the upper cover tends to fall out, a slight blow with a hammer as shown will keep it in place.

step 6 – electric connections

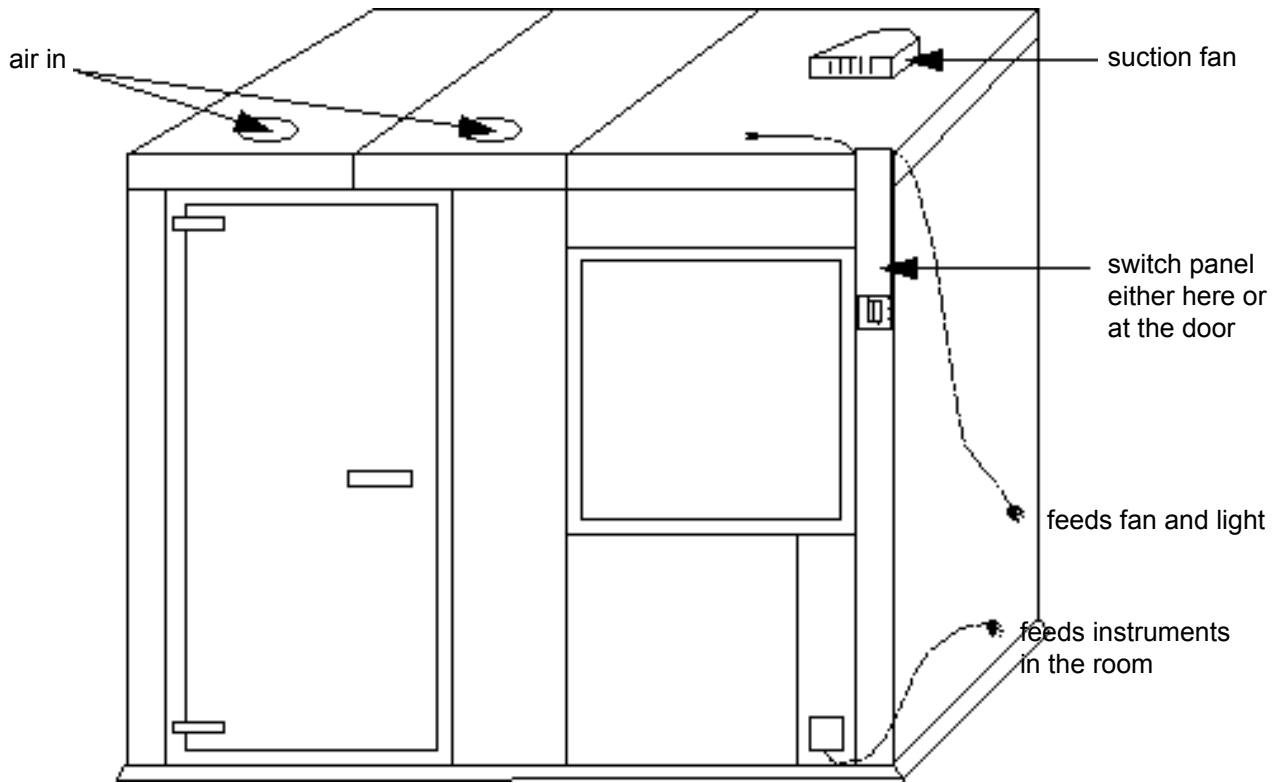

the four conductor cable goes through a hole drilled in the roof to the light fixture, and the three conductor cable to the fan housing (green/yellow is earth)

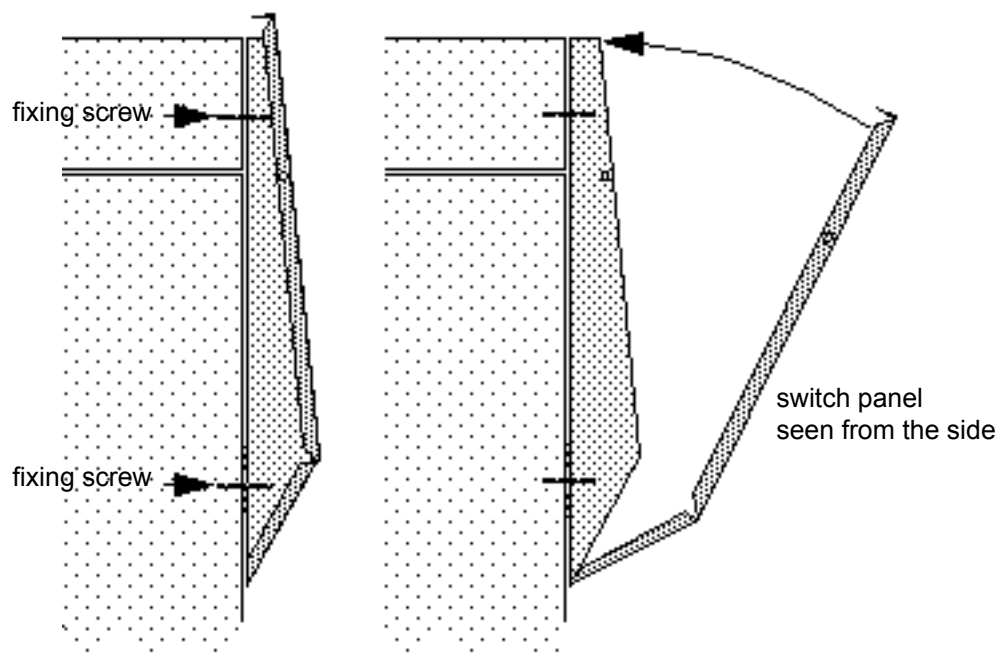

Installing the light

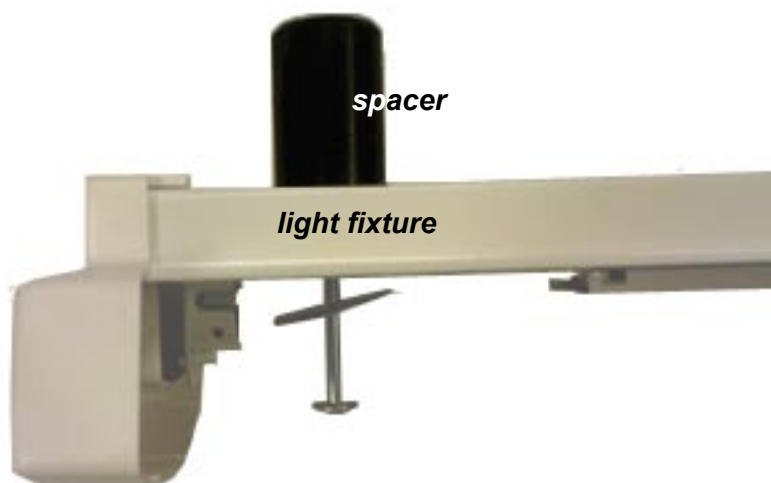

Remove the cover and fluorescent light tubes from the light fixture.

Remove the small plastic lid in the centre of the light fixture (the one furthest away from the block terminal).

Hold the light fixture up against the ceiling and mark the two holes at each end and the one for the electric cord in the centre.

Use the big starret to make holes for the spacer in the ceiling slates (do this by simply holding the starret in your hand and turn it).

Drill a 3.2 mm hole in the centre of the holes you just made with the starret.

Drill a hole with the long drill in the centre marking for the electric cable, right through the ceiling. Use the smaller starret in the centre hole from the inside and up as far as possible and then from the outside, down as far as possible.

Slightly fasten the spacers in each hole.

Fasten the light fixture on the roof and pull the electric cord through it and through the ceiling, leaving about 150 mm sticking out on the inside.

Fasten the light fixture with the washers as shown in the picture.

Connect the electric cable.